



HANDLE CONVERSION KIT INSTALLATION

Kit X567000 contains: 1 red (hot supply) cartridge and 1 blue (cold supply) cartridge.

INSTALLATION

1. Turn off hot and cold water supplies.
2. Using a crescent wrench or socket, untighten the existing cartridge and then pull out.
3. On the new cartridge, make sure the bottom gasket (red or blue) is in place. Insert new cartridge into valve body. If a torque wrench is available, set at 19 foot-pounds and screw cartridge into valve body. If a torque wrench is not available, use a crescent or socket to screw the cartridge into valve body. DO NOT over tighten as this can cause damage to the ceramic discs. Check that the upper O-ring is seated properly.
4. Install handle component in the order shown below.
5. Turn on hot and cold water supplies.

REMOVE
EXISTING
CARTRIDGE



EXISTING 1/2" VALVE

INSTALL NEW
CARTRIDGE

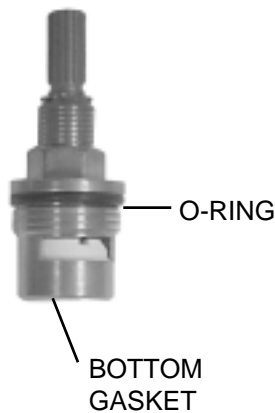

NEW STYLE HANDLE
COMPONENTS

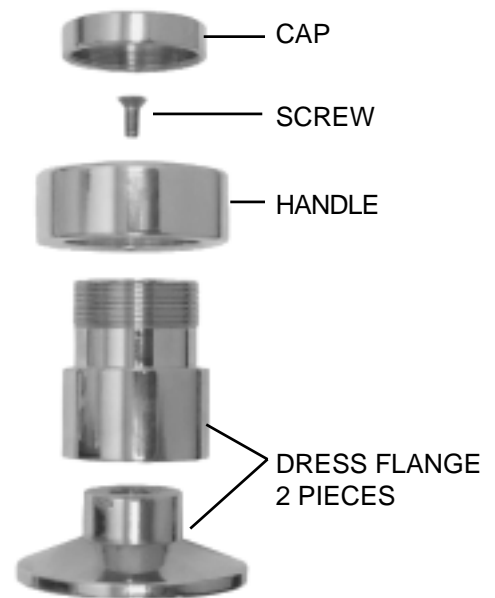

JACUZZI WHIRLPOOL BATH

Jacuzzi Whirlpool Bath National Headquarters
P.O. Drawer J, Walnut Creek, CA 94596 (510) 938-7070

©2003 Jacuzzi Whirlpool Bath Y361000 10/03



Printed on Recycled Paper

Printed in U.S.A