

Hand Held Shower Head

Operating Instructions

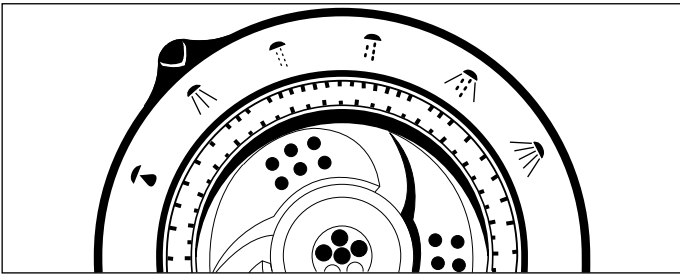

SIX SHOWER SELECTIONS

To select a spray setting, turn the control ring to any one of the shower selections at any time.



Pause

Reduces water flow lathering up.



Turbo Pulse

Powerful turbo massage.



Center Spray

A concentrated, full force spray.



Spray Pulse

Pulsating massage combined with a soothing body spray



Pulse

A steady pulsating spray massage



Outside Spray

A generous shoulder-to-shoulder spray.

Your hand held shower head uses no more that 2.5 gallons of water per minute.

NOTE: Sudden water temperature change, hot or cold, may be noticed when changing the "pause" setting. Always turn the shower head away from you when changing to or from the "pause" setting.

As with any water conserving shower head, temperature changes may also occur due to rapid loss of water pressure. This may be caused by the use of a dishwasher, washing machine, or toilet.

MAINTENANCE

Cleaning is required when mineral deposits appear on the spray orifices. Spraying shower head face with shower cleaning products or soaking and cleaning with household vinegar will help remove mineral build up.

Do not clean or rinse any part of the shower head with harsh chemicals, heavy duty cleansers or abrasives as this may damage parts or finish.

To prevent the possibility or personal injury from loose water-propelled parts, periodically inspect all threaded connections to ensure they are secure.

Removal of the Spray Cup and Spray Ring

To remove spray cup, grab firmly onto the control ring. With the other hand simply twist the spray cup counterclockwise and pull it away from the shower head to remove. The spray ring may or may not come off with the spray cup. If it does, gently pull and separate the spray ring from the spray cup. If the spray ring stays intact to the shower head, gently pull it away from the shower head as it should snap off easily.

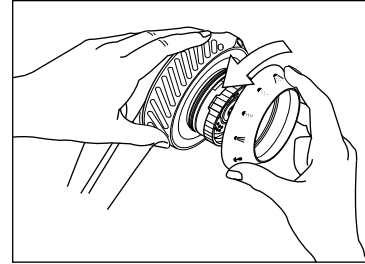

Reinstalling Spray Cup and Spray Ring

To reinstall the spray cup, line up the two grooved notches on either side of the spray ring to the two tabs on either side of the shower head. Snap the spray ring onto the shower head. Grab hold firmly of the control ring and twist the spray cup clockwise onto the shower head until it comes to a firm stop. The spray selection graphics should line up with each mode as the control ring is rotated left and right.

It's a good idea to clean the protective blue filter screen in your shower head at least once a year or whenever you notice a substantial drop in water pressure from the shower head. To clean the filter in depth, unthread the pivot ball from the shower arm using a soft cloth and wrench. Unscrew the blue filter screen with your fingers, rinse under the tap, and reassemble.

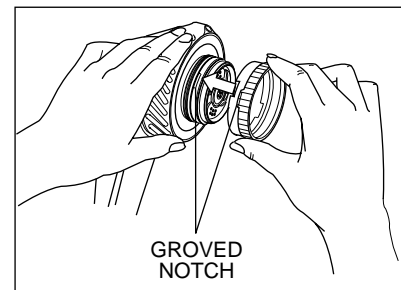
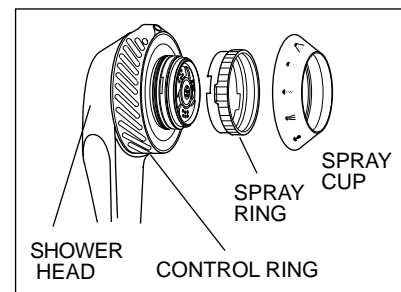

**PRODUCT SPECIFICATIONS ARE SUBJECT TO CHANGE WITHOUT NOTICE.
USE INSTALLATION INSTRUCTIONS SUPPLIED WITH PRODUCT.**

